

BUILD_ME

IKI Project: Accelerating 0-emission building sector ambitions in the MENA Region

Outlook of 3rd Phase

National Kick off Third Phase of BUILD_ME

Beirut, Lebanon

March 2023

Main objective of the third phase of BUILD_ME

Investments in energy-efficient buildings by international (and national) banks have **increased** in Egypt, Jordan and Lebanon and their **political frameworks for more ambitious GHG savings** in the building sector has been improved



1 Technical Framework



2 Financial Framework



3 Dissemination and Capacity Building



4 Political and Reg. Framework

Expected outcomes of the third phase of BUILD_ME

Financial institutions have used the BEP tool and/or the national classification system for evaluating bankable projects in target countries

Knowledge for low-energy buildings is increased in the target countries

The levels of EE of buildings has increased in the political frameworks



1 Technical Framework



2 Financial Framework



3 Dissemination and Capacity Building



4 Political and Reg. Framework

1.1 Technical framework

Develop new features and integrate them in the BEP Tool

Cover as well existing buildings in the BEP tool calculation



1.1 Technical framework

Elaborate further “modules” to accelerate the transition

Develop a building component database

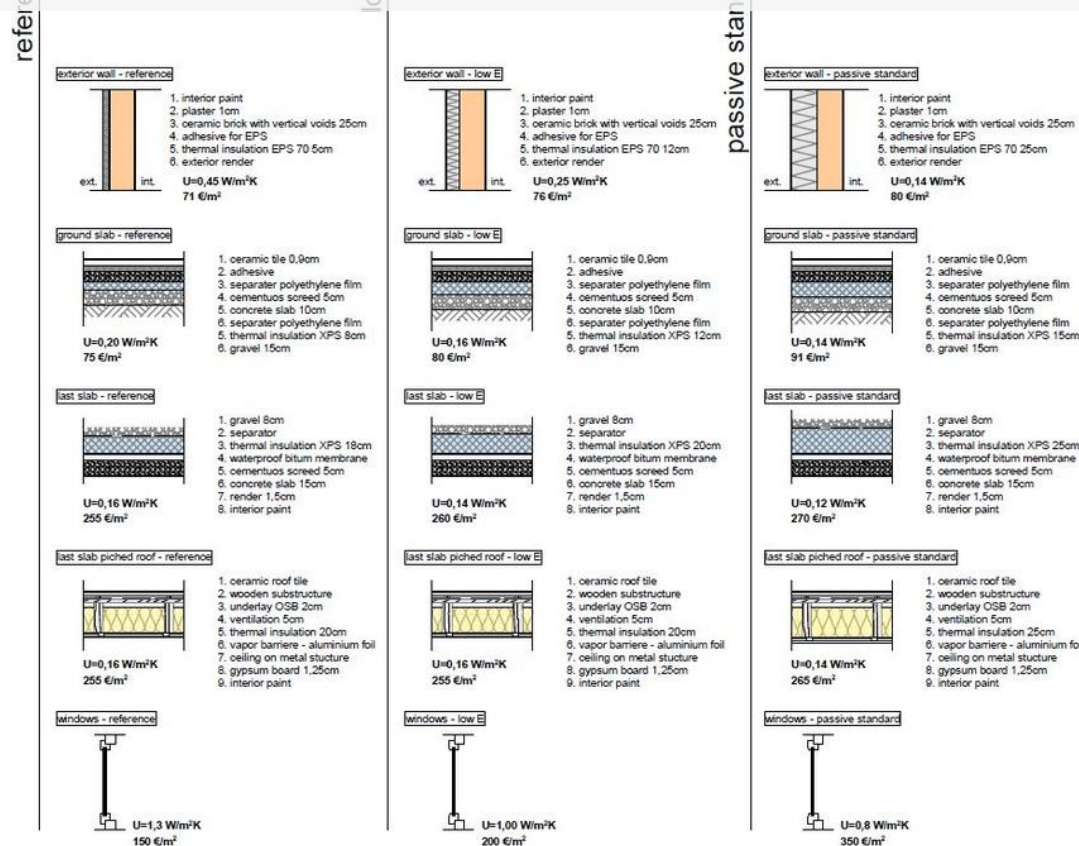

s: Maties et al. (2019). Form, Cost and Energy Efficiency for a Single-Family House)

Elaborate a country specific definition for ZEB



s: izzat marji group headquarters green building, Amman

1.2 Technical framework

Implement the roll out an Energy Performance Certificate (EPC)

“Energy performance certificates (EPC) indicate the energy performance of a **building or a building unit, calculated according to a methodology complying** with the common general framework adopted at the national or regional level”
[S: EPBD]

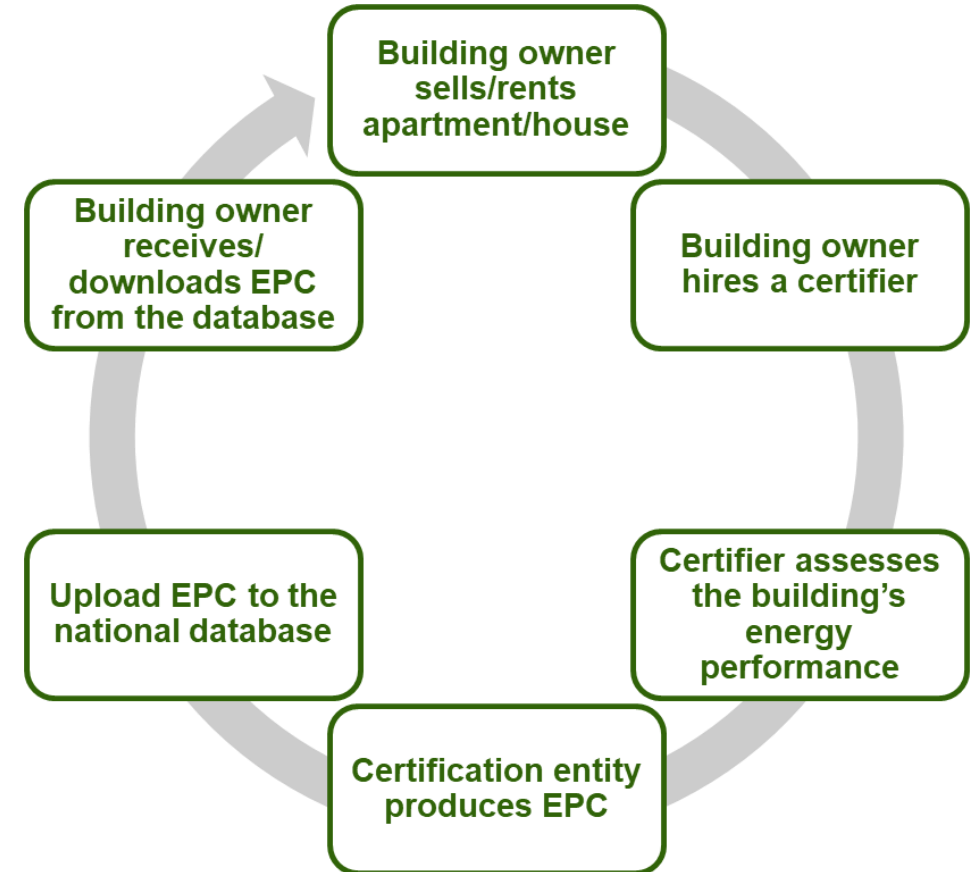
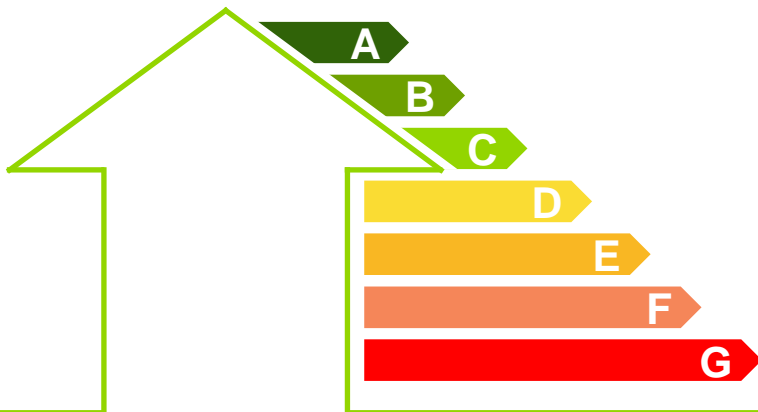

2. Financial framework

FIs/Banks join the project and are connected with project developers



FIs and Banks sustainable finance offerings for green buildings

- Survey to list the financial products available.
- Identify the target groups of the financial products.
- Identify the conditions of the sustainable finance offerings.
- Summarize the finance conditions for pilot project developers.

Matchmaking



BUILD_ME team will facilitate and coordinate the collaboration between project developers and FIs to use the project BEP Tool.



Project developers of low energy buildings

- Identify a long list of green buildings project developers.
- Identify the key characteristics of the projects including size, building types, and ownership structure.
- Understand finance-related decisions

3.1 Dissemination and Capacity Building

Use several “channels” to increase the awareness

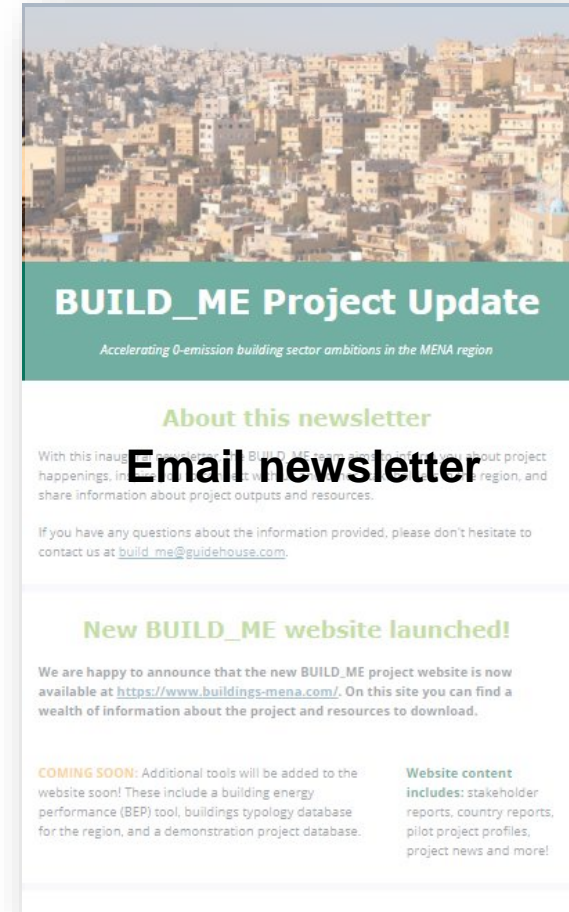
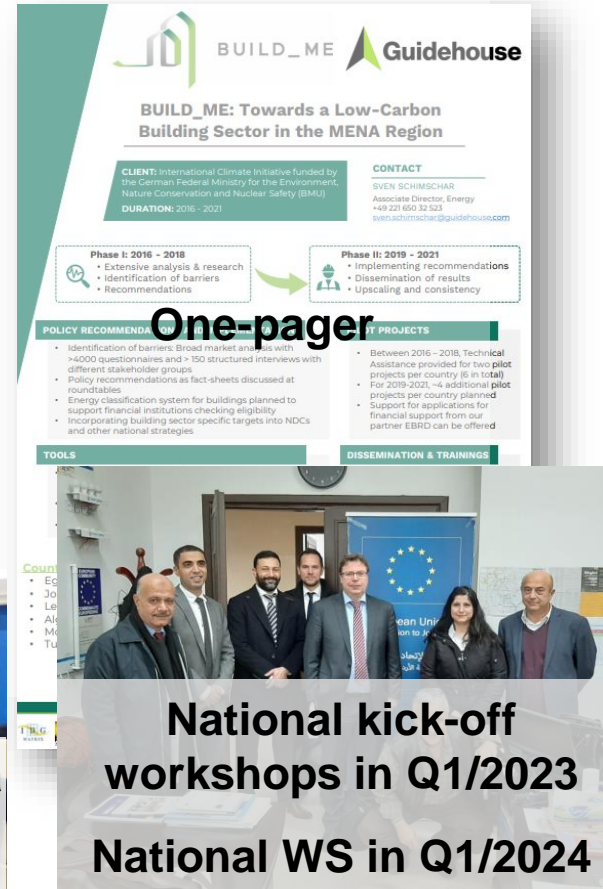
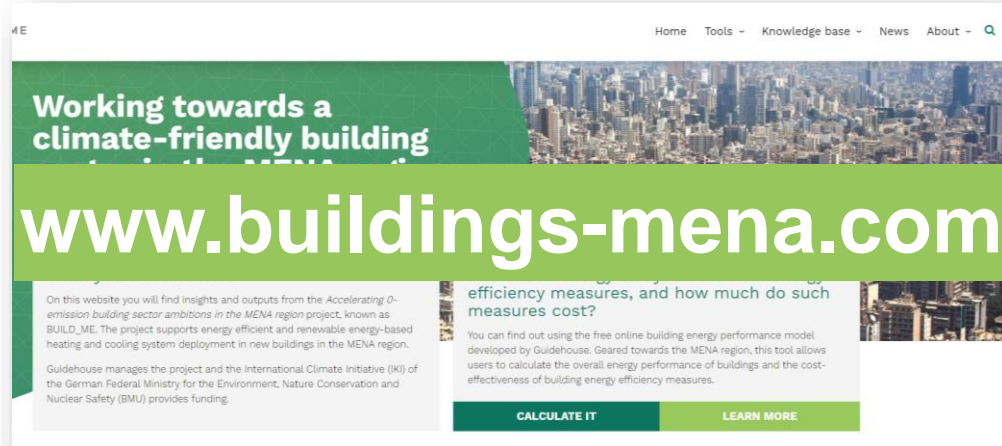

3.2 Dissemination and **Capacity Building**

Target group specific trainings will be offered on the EPC process

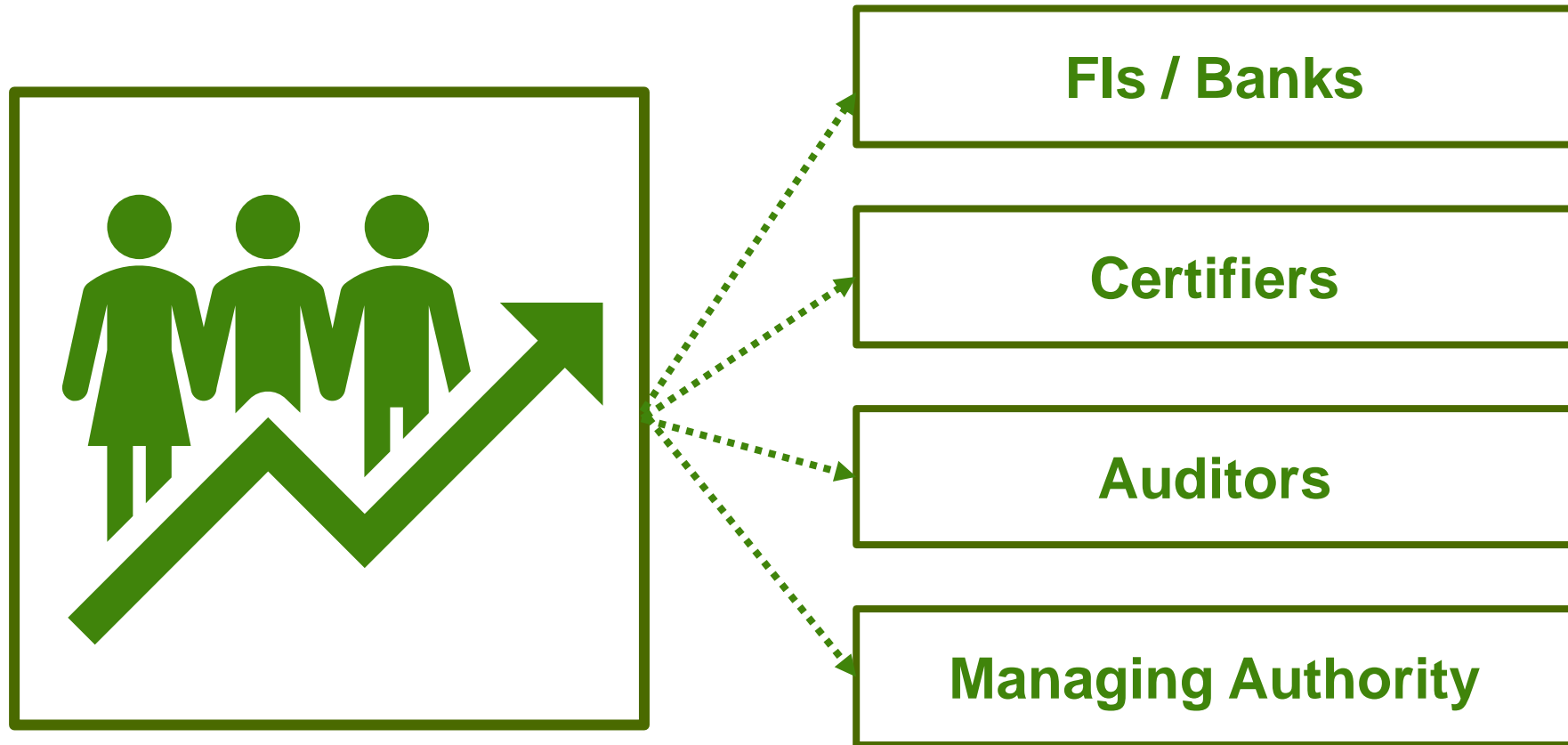

4. Political and Regulative Framework

Support the improvement of the pol. and reg. framework

Strategies e.g., NEEAPs

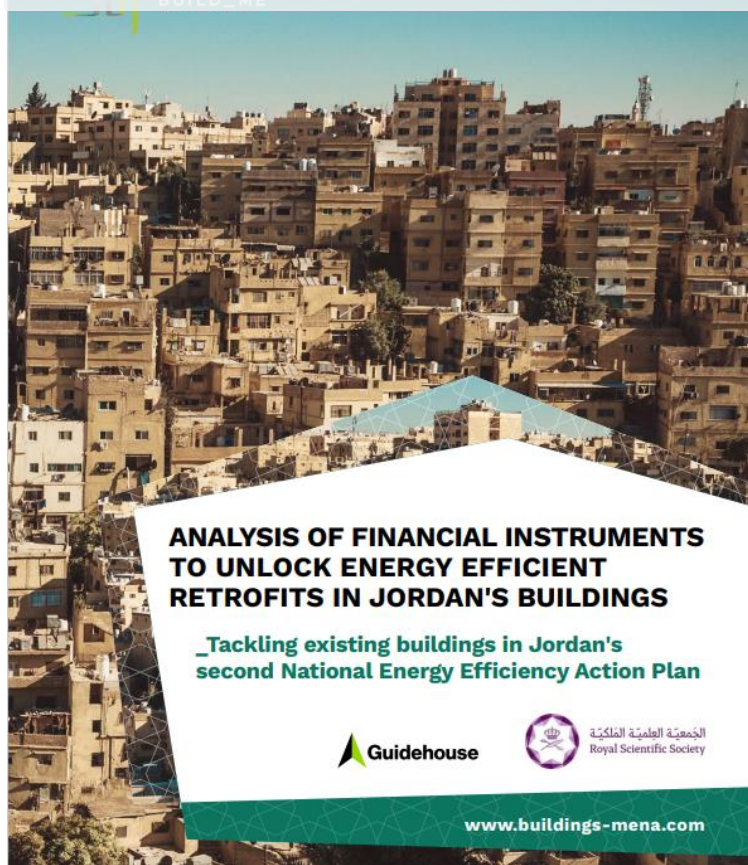

Regulations e.g., EEBCs

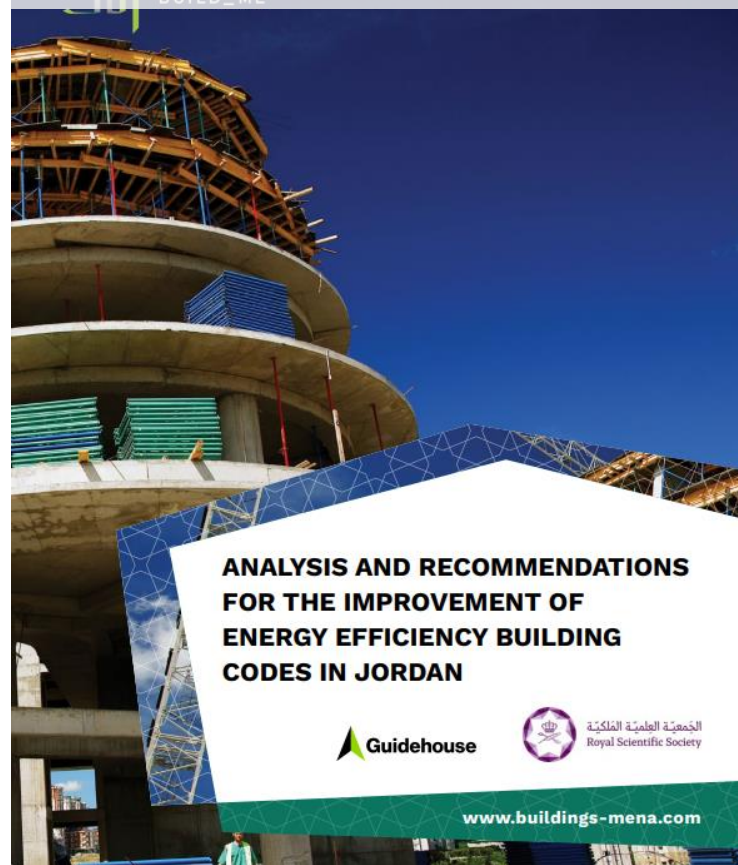

Ad hoc policy support



Contact

Dr. Sorina Mortada

sorina.mortada@lcec.org.lb

Ammar Fadlallah

ammar.fadlallah@lcec.org.lb

Eslam Mahdy

Eslam.Mahdy@guidehouse.com

Riadh Bhar

Riadh.Bhar@guidehouse.com

www.buildings-mena.com

